

NAPA SOLANO CHAPTER ICC

Article 210 – 52 Branch Circuits

General Provisions: In every kitchen, family room, dining room, living room, parlor, library, den, sun room, bedroom, recreation room or similar room or area of dwelling units, receptacle outlets shall be installed so that no point along the floor line in any wall space is more than 6 ft, measured horizon, from an outlet in that space, including any wall space 2 ft or more in width and the wall space occupied by fixed panels in exterior walls, but excluding sliding panels in exterior walls. The wall space afforded by fixed room dividers, such as freestanding bar-type counters or railings, shall be included in the 6-ft measurement.

As used in this section, a "wall space" shall be considered a wall unbroken along the floor line by doorways, fireplaces, and similar openings. Each wall space 2 ft or more wide shall be treated individually and separately from other wall spaces within the room. A wall space shall be permitted to include two or more walls of a room (around corners) where unbroken at the floor line.

Receptacle outlets shall, insofar as practicable, be spaced equal distances apart. Receptacle outlets in floors shall not be counted as part of the required number of receptacle outlets unless located within 18 in. of the wall.

The receptacle outlets required by this section shall be in addition to any receptacle that is part of any lighting fixture or appliance, within cabinets or cupboards, or located over 5 1/2 ft above the floor.

Receptacles are required to be located so that no "point" in any wall space is more than 6 ft from a receptacle. This rule intends that an appliance or lamp with a flexible cord attached may be placed anywhere in the room and be within 6 ft of a receptacle, thus eliminating the need for extension cords, as illustrated in Figure 210-24).

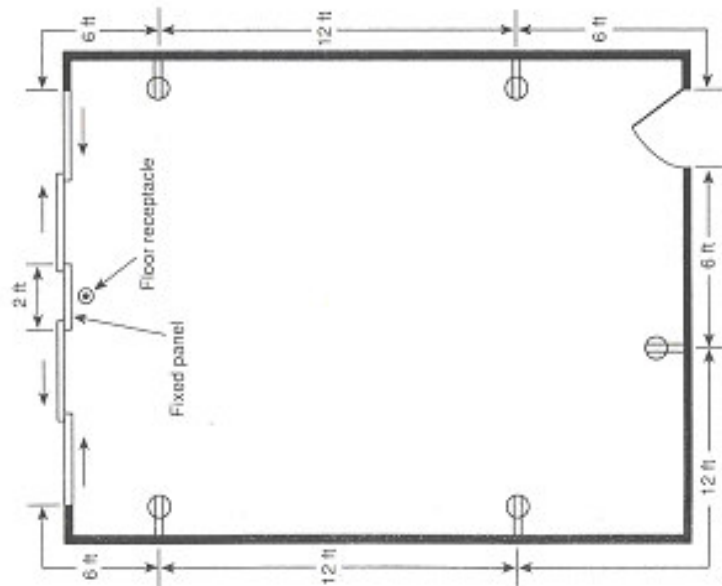

Figure 210-24

DWELLING RECEPTACLE OUTLETS	DETAIL E2	THIS DETAIL APPROVED BY:		
	DATE: 7/13/04	FAIRFIELD _____	SUISUN _____	DAVIS _____
	REVISED:	VAVAVILLE _____	NAPA _____	NAPA CO. _____
		DIXON _____	RIO VISTA _____	SOLANO CO. _____
		BENECIA _____	VALLEJO _____	MARTINEZ _____